

# G-SHOCK

## PAPER CRAFT

This model was designed for Papercraft and may differ from the original in some respects.

Scale 1/1

### DW-6900 Assembly instructions



Mountain fold (dashed line)

← Insert



Valley fold (dotted and dashed line)

← Apply glue



✂ Cut out

#### 1 Tool & Materials

- A4 plain paper
- Utility knife
- Scissors
- Utility knife board
- Glue or glue tape

#### 2 Cut out all the parts

Cut out (blue area)

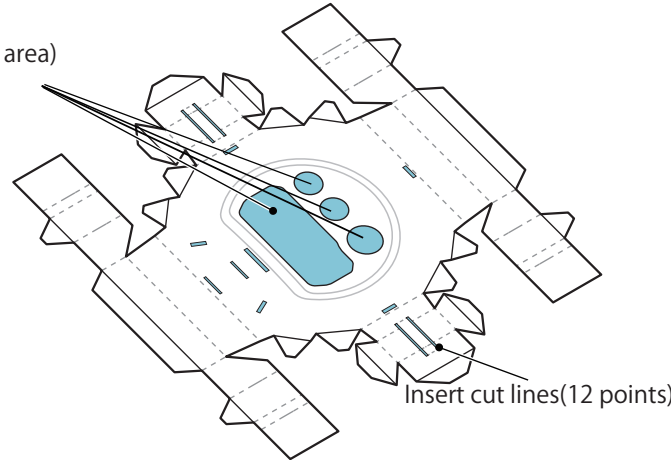

#### 3 Assemble the case

A

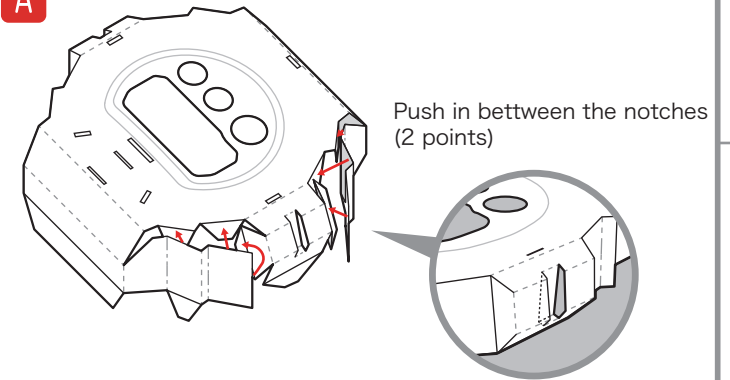

#### 4 Assemble the bezel, button and bezel parts

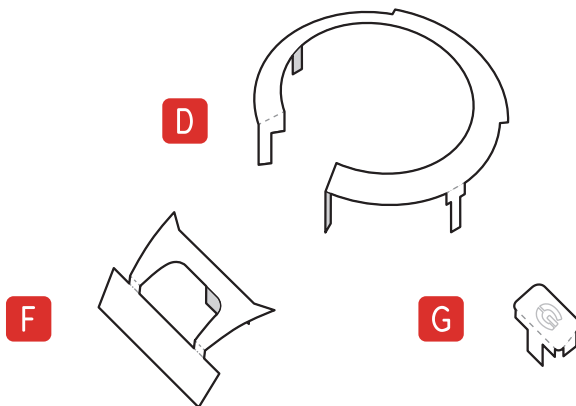

#### 5 Joint the bezel into the cut line

Fix with the glue tape from back side (1 point)

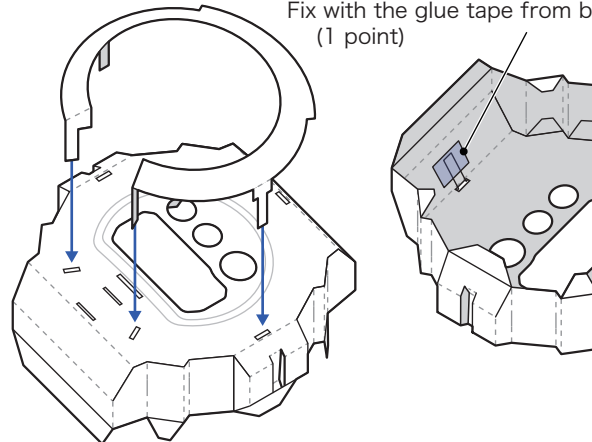

#### 6 Affix the button and bezel parts

Apply glue on ★

Tips for toughness structure

**All directional covering**  
Knobby protrusions from the case and bezel protect the buttons and crystal from direct shocks.

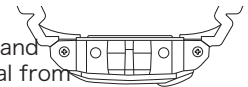

# G-SHOCK

## PAPER CRAFT

This model was designed for Papercraft and may differ from the original in some respects.

Scale 1/1

### DW-6900 Assembly instructions



Mountain fold  
(dashed line)

← Insert



Valley fold  
(dotted and dashed line)

← Apply glue



Output

**7** Fold the front band and rotation stopper

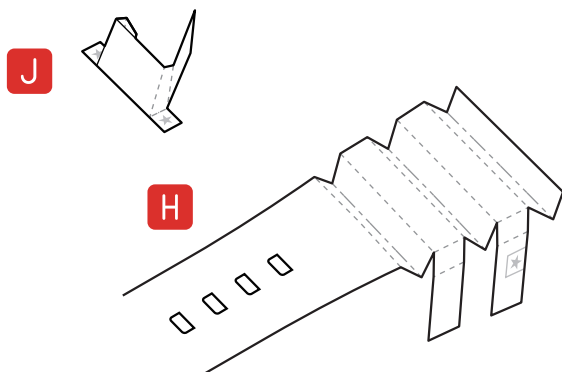

**8** Assemble the band and rotation stopper

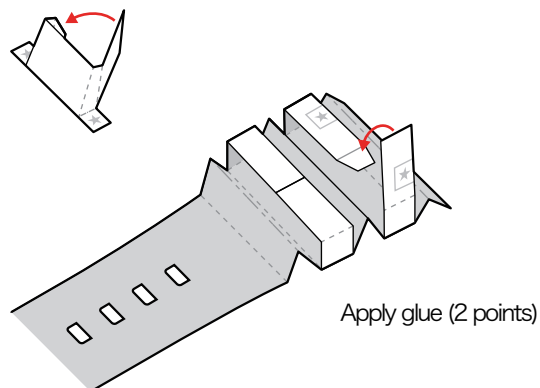

**9** Affix the rotation stopper to the band

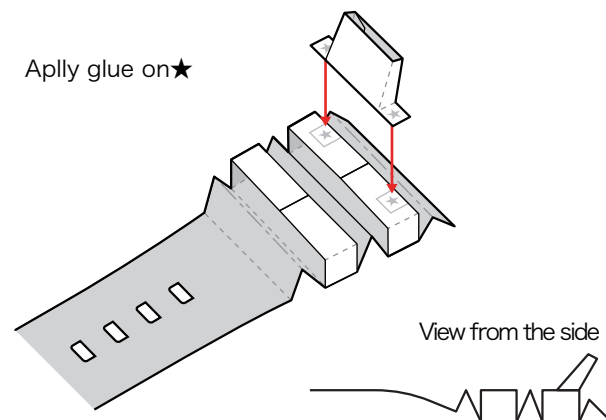

**10** Role the buckle pin

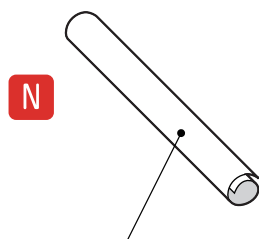

Roll into a cylinder with a diameter of about 2mm.  
(It is easy if you wrap around toothpick)

**11** Insert the buckle pin

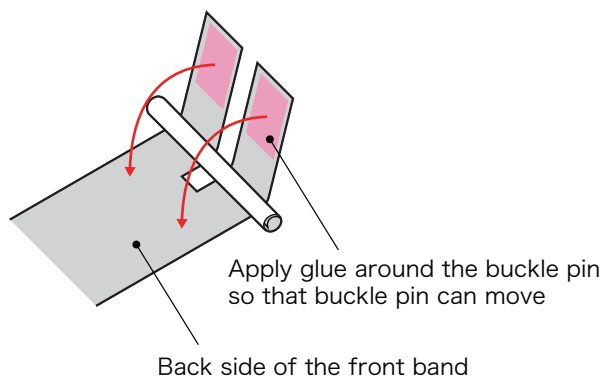

**12** Affix the buckle tongue and make the crease

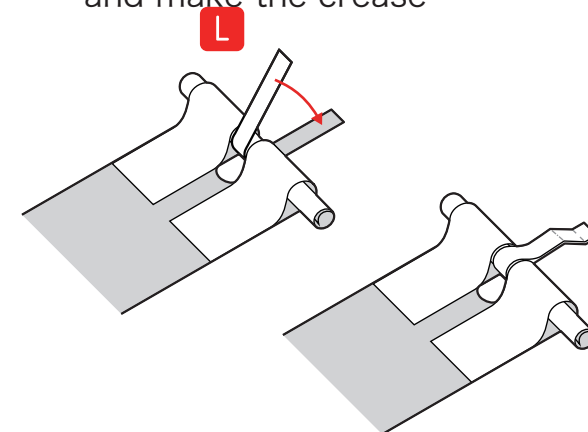

# G-SHOCK

## PAPER CRAFT

This model was designed for Papercraft and may differ from the original in some respects.

Scale 1/1

### DW-6900 Assembly instructions



Mountain fold (dashed line)

← Insert



Valley fold (dotted and dashed line)

← Apply glue



Cut/punch

#### 13 Affix the buckle and make the crease

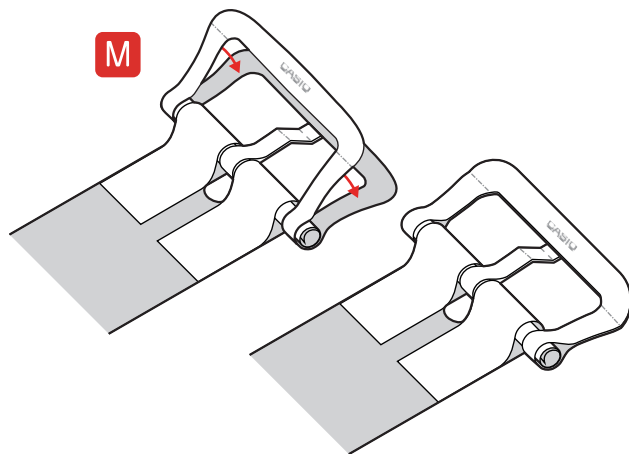

#### 14 Affix the back side of the band

Align the guide line of back side

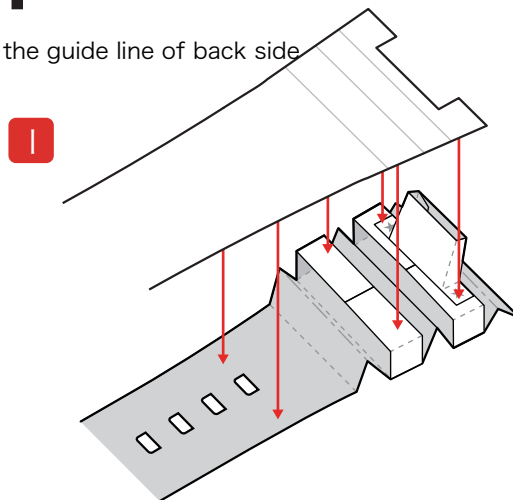

#### 15 Cut out the band holes

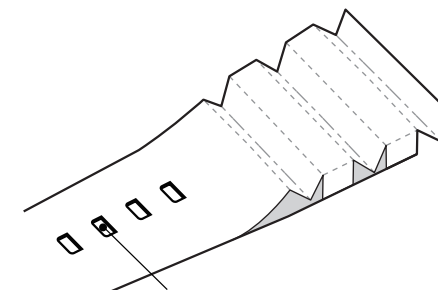

Make a hole with the bands stacked

#### 16 Affix the band loop

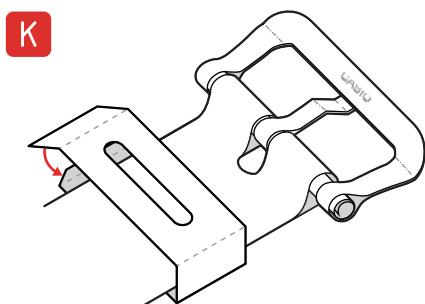

#### 17 Assemble the module

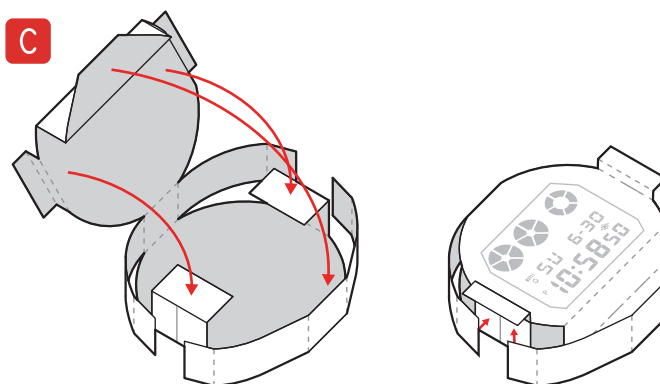

#### 18 Assemble the shock absorber

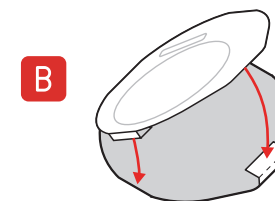

# G-SHOCK

## PAPER CRAFT

This model was designed for Papercraft and may differ from the original in some respects.

スケール 1/1

### DW-6900 Assembly instructions



Mountain fold  
(dashed line)

← Insert



Valley fold  
(dotted and dashed line)

← Apply glue



Output

#### 19 Affix the module to the case

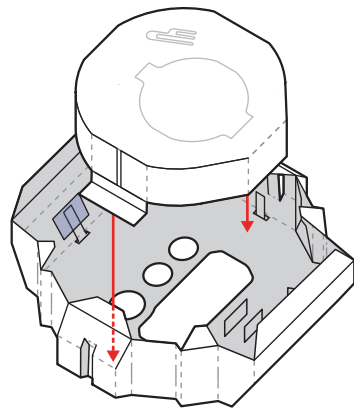

Apply glue on ★  
(Check the display position from the front side)

#### 20 Affix the shock absorber to the module

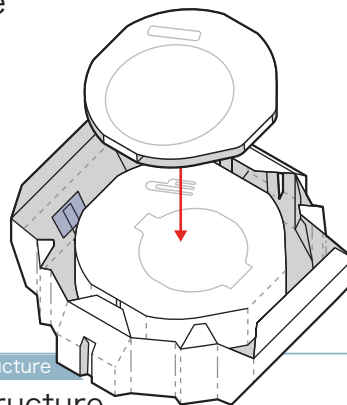

Tips for toughness structure

##### Hollow case structure

The module is floated in the air inside a case with a hollow structure.

#### 21 Affix the back panel to the case

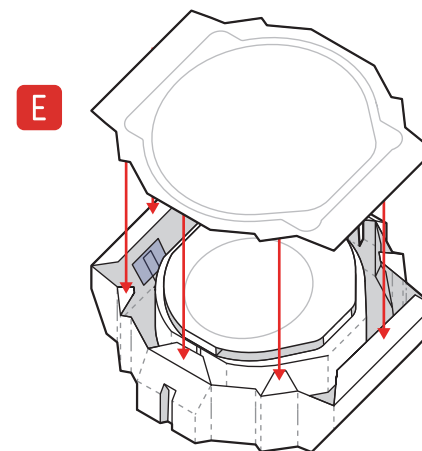

#### 22 Affix the band to the case



Apply glue on ★

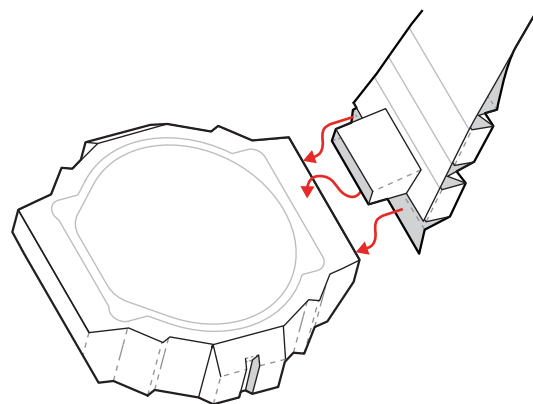

Tips for toughness structure

##### All directional covering

The band connection section is stiffly curved, moreover, to shield the back of the case against direct shocks.

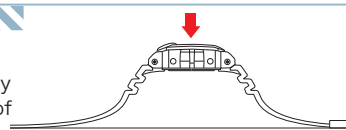

#### 23 Complete!!

